

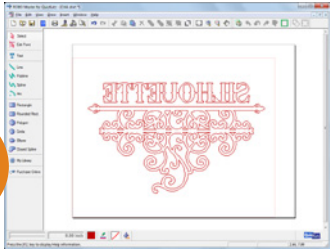

Heat Transfer starter guide

1



Select a Silhouette design or font and lay out your design in the Silhouette software. **IMPORTANT:** Be sure to mirror the image horizontally so text will appear backwards on the screen.

2



Feed the heat transfer material into the Silhouette without a cutting mat with the clear plastic side on the bottom. (Peel up a corner to check which side has the clear plastic transfer sheet.) Use the blue cap and a thickness of 16-18 for smooth heat transfer material, and the pink cap and a thickness of 28-33 for flocked heat transfer material.

3

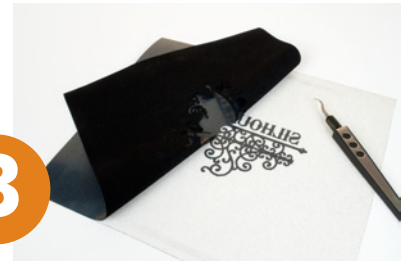

Peel the negative space of the design off the plastic backing leaving only the design you want to transfer on the clear plastic transfer sheet.

4



Position the design on the desired surface face down so that you see it through the clear transfer sheet. Your design is now right-reading.

5

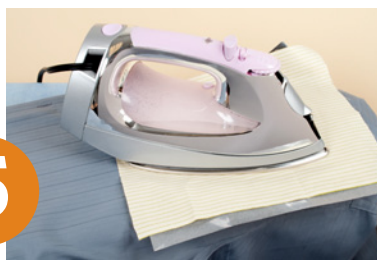

Place a cloth over the design and place a heated iron on top pressing firmly into the design for 45-60 sec. Repeat this process until the entire design is pressed. **IMPORTANT:** Do not set iron to more than 300 degrees (typical cotton setting).

6



Remove the iron and cloth and gently peel up the transfer sheet. If the heat transfer material continues to stick to the transfer sheet, replace the cloth and iron again.

7

You are now ready to showcase your heat-transferred masterpiece!



For longer lasting results, hand wash and dry clothes inside out. Use extreme caution when operating a hot iron. Keep out of reach of children.

NOTE: Silhouette heat transfer material will not adhere to nylon.